

# Social and Health Care Services Network Meeting

## Stuttgart, Germany 2024

### Practical Information

**Date:** Thursday, 11 and Friday, 12 July 2024

**Venue:** Evangelische Heimstiftung GmbH, Hackstraße 12, 70190 Stuttgart

#### How to get from the airport to MotelOne

To reach Stuttgart Hauptbahnhof (main train station) you can take STB U6 (direction Gerlingen). The MotelOne is located right next to the main station. Tickets can be purchased at the airport or online: <https://www.bahn.de/>

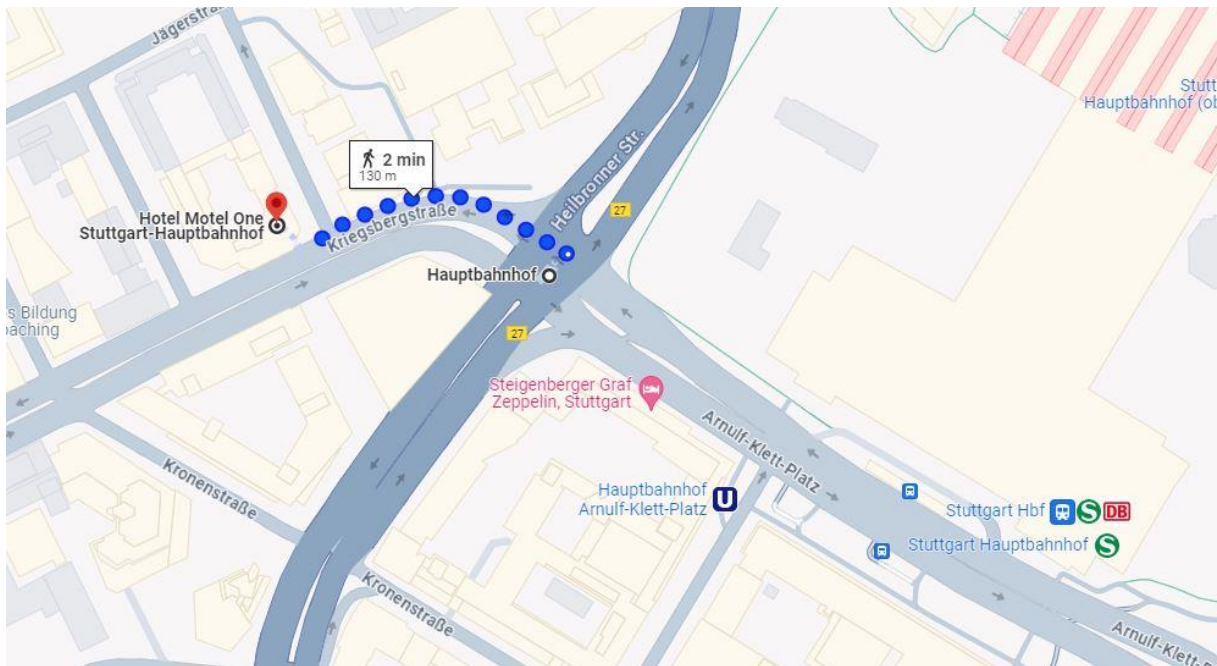

#### How to get from the MotelOne to Evangelische Heimstiftung (Meeting Venue)

*To get from MotelOne to the Evangelische Heimstiftung you have to options:*

1. Take metro (U1 direction: Lutherkirche Fellbach/ U9 direction Hedelfingen) from the station "Hauptbahnhof Arnulf-Klett-Platz" to the station "Stöckach". It will take you approximately 15 minutes.
2. Have a 30-minutes-walk. I would recommend you to have a nice morning walk through the "Schlossgarten" (see red lines in map below) 😊

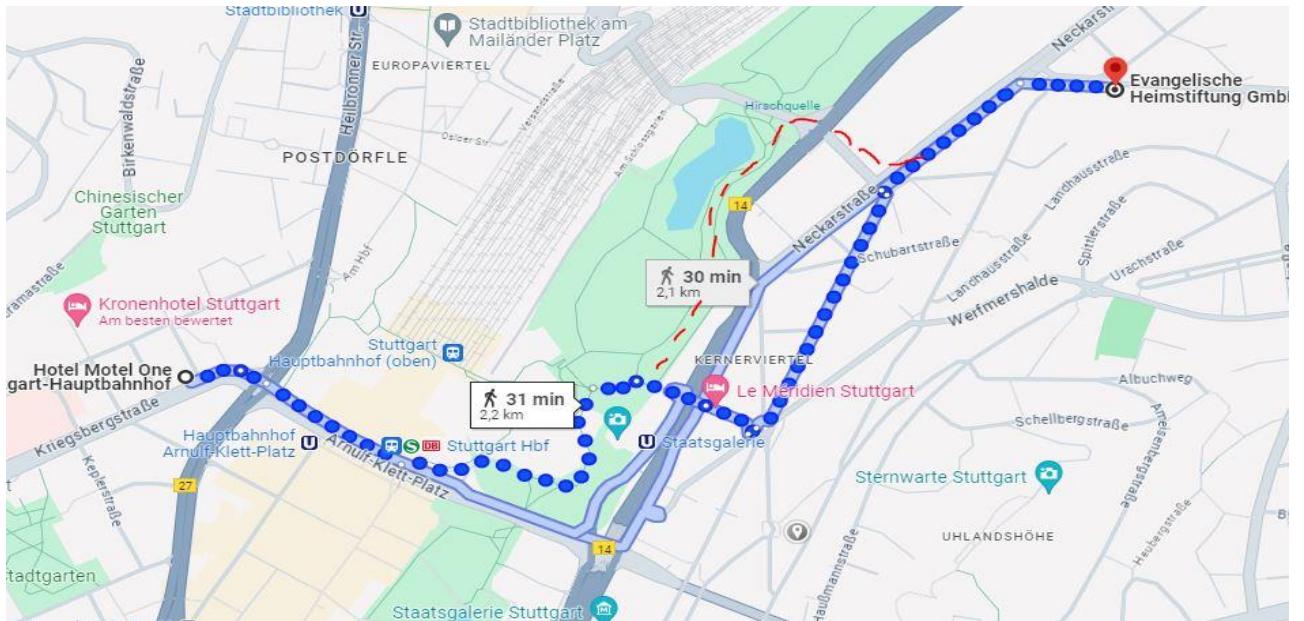

### How to get from Königin-Olga-Residenz to MotelOne?

After the study visit in the Königin-Olga-Residenz (Johannesstraße 4, 70176 Stuttgart) you will have approximately 2 hours free time until our dinner. If you wish to return to the MotelOne during this time, you can take the tram (S2 / S3/ S4/ S6/ S60) from “Stuttgart Feuersee” to “Stuttgart Hauptbahnhof” (15 minutes) or have a 30-minutes-walk.

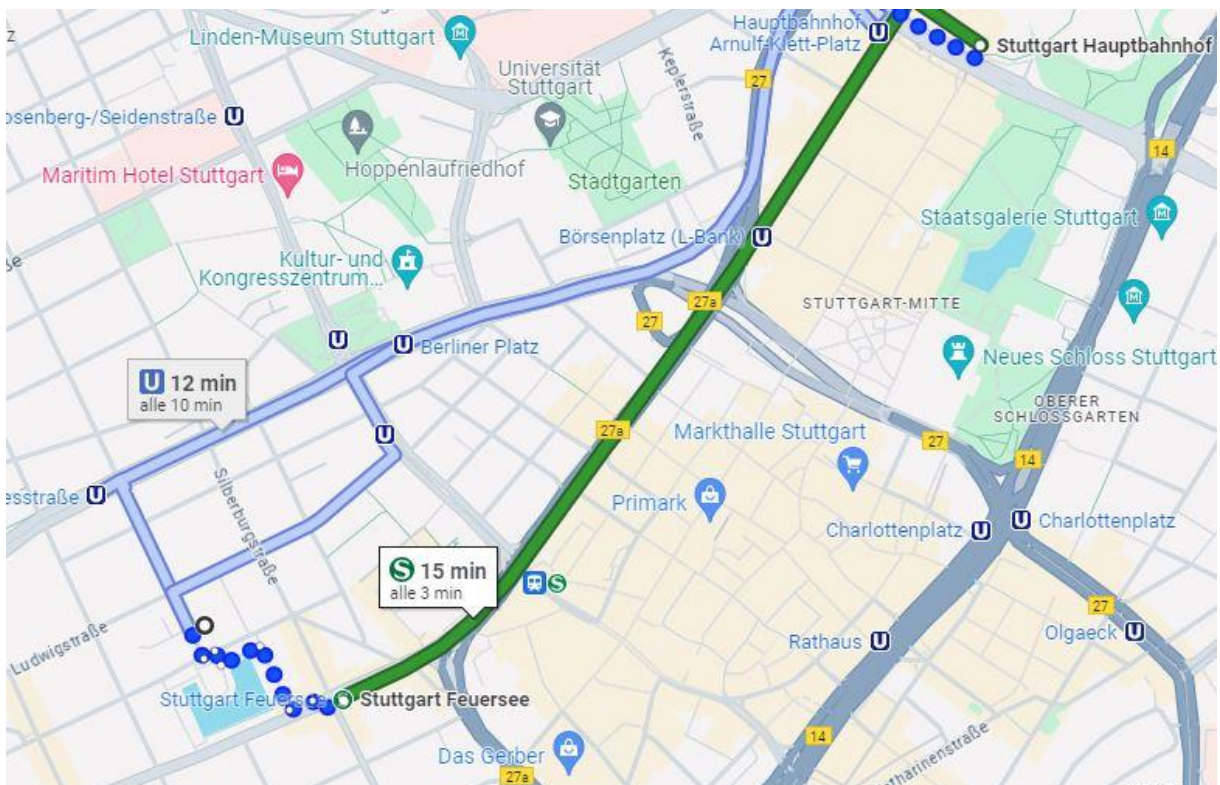

## How to get from MotelOne to Weinstube Fröhlich (Dinner)

Thursday evening (at 6.30 pm) we will have dinner at Weinstube Fröhlich (Leonhardstraße 5, 70182 Stuttgart). From Motel One you can take the metro U11 (direction Neckar Parc Stadion) from "Hauptbahnhof Arnulff-Klett-Platz" to "Rathaus". Again, the ride will take you 15 minutes. By foot it will be 30 minutes.

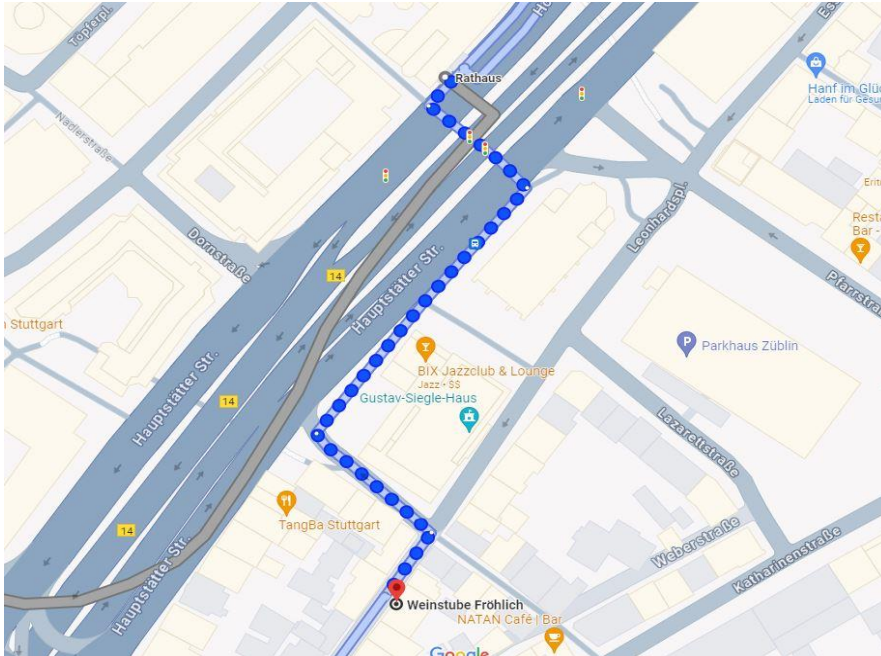

Some more days in Stuttgart? Here some recommendations what to do...

- **Public Viewing:**  
There will be semi-finals (10 July) and finals (14 July) of the European Football Championship 2024 in Germany. The matches won't be in Stuttgart, but there will be Public Viewings all over the city: <https://uefaeuro2024.stuttgart.de/en/host-city-stuttgart/>
- **Staatsgalerie Stuttgart:** The Staatsgalerie is one of Germany's great art museums. The collection comprises painting, sculpture and graphic art from the Middle Ages to the present, including many masterpieces and an internationally outstanding collection of modern art. Special highlights are Oskar Schlemmer's »Figurinen zum Triadischen Ballett« from the early 1920s, the famous »Rückenakte« (1909–1930) by Henri Matisse, numerous works by Picasso, including the sculpture group »Die Badenden« (1956) and the Joseph Beuys Room, which was still personally furnished by the artist. <https://www.staatsgalerie.de/en>
- **Fernsehturm:** The world's very first television tower is to be found in Stuttgart. <https://www.fernsehturm-stuttgart.de/en/>
- **Mercedes/ Porsche Museum:** The Mercedes-Benz Museum in Stuttgart celebrates the automobile invented by Carl Benz in 1886: it relates its history and tells its stories, bringing both alive by placing them in the context of technology, day-to-day

life, social history and popular culture. More than 160 vehicles of all types are the main protagonists. They range from some of the oldest automobiles ever built to legendary racing cars and futuristic research vehicles. <https://www.mercedes-benz.com/en/art-and-culture/museum/>

- **Wilhelma:** Wilhelma is the only zoological-botanical garden in Germany and one of the most biodiverse zoos in the world. Promoting domestic and global biodiversity, botanical collections and scientific research work are among our most important missions. <https://www.wilhelma.de/en/>
- **Vineyards / Grabkapelle:** Feel like a little hike through the vineyards? The “Grabkapelle” (burial chapel) is probably the most romantic building in Stuttgart. Locals also affectionately call it the “Swabian Taj Mahal”.  
<https://www.stuttgart.de/tourismus/sehenswuerdigkeiten/grabkapelle-wuerttemberg.php?form=translationDisclaimer-Mzl1Nzg3ODQ&action=submit#translationDisclaimer-Mzl1Nzg3ODQ>

## EMERGENCY CONTACTS

- Eurodiaconia: Kewan Mildred, +32485200642
- Evangelische Heimstiftung: Hanna Kaspar, +49 160 91755780
- Ambulance and police: 112